

HAPPINESS STARTS IN YOUR KITCHEN

Since its inception in 1996, FOTILE has carved a niche in the industry of being the No 1 high-end kitchen appliances brand in China, specializing in developing built-in kitchen appliances like hoods, hobs, ovens, combi ovens, microwave ovens, steam ovens and sink dishwashers.

We have the largest R&D center in the world, covering an area of **8000sqm**. With technology, innovation design and performance as the key factors in Fotile manufacturing, we have achieved **13000+** patents in product and **3500+^{**}** in invention, bringing innovative and good quality product to over **17 millions** of families around the world. FOTILE commitments to excellence not only bringing satisfaction to our customers, we have won a numerous international accolade namely RedDots design awards, IF Product Design Award that uplifting the industry standard of designs and product innovations.

At FOTILE, our business is built on the foundation of product innovation and creating kitchen appliances that are functional, stylish and family oriented. That is why FOTILE is constantly inventing, designing and creating extraordinary products while maintaining its reputation as a leading kitchen expert that puts families at the first place.

Marking a remarkable milestone, FOTILE has launched its first largest kitchen appliances gallery named the "Fotile Style," located at TaoJiang road, Shanghai, in year 2012. This gallery showcasing the brand's most prestigious kitchen appliances. A 'futuristic corner' is introduced in this gallery, allows visitors to take a glimpse into some of FOTILE'S most innovative technology.

With over 20 years of experience in servicing Malaysian customers, FOTILE Marketing Sdn.Bhd as the sole distributor of FOTILE kitchen appliances in Malaysia, has the expertise to offer functional and stylish kitchen appliances that suited to Asian cooking.

Today, FOTILE Malaysia enjoys its position as a reputable premium kitchenware brand in Malaysia with a strong following of happy and satisfied customers. We strive to innovate our product and service, providing a full spectrum of cooking solutions that caters to every Malaysian kitchen need.

- Dusseldorf, Germany; Osaka, Japan; Ningbo, China ; three global centers
- Revise international standards* for extractor hoods

* IEC 60335-2-31: Household and Similar Electrical Appliances-Safety-Part

2-31: Particular Requirements for Range Hoods and Other Cooking Fume Extractors

** Data as of Aug 31st, 2024

www.fotile.com.my

FOTILEMalaysia

+603-8602 9289 (HQ)

016-207 8978

FOTILE



Nature's Minerals in Every Drop
For Healthy Life



Nature's Minerals in Every Drop for Healthy Life

Minerals are essential for bodily functions, metabolism, and water balance. Between 5% and 20% of these vital minerals are derived from drinking water. Studies consistently show that minerals in water, particularly calcium and magnesium, are more easily absorbed by the body than those in food, making water an important source of these nutrients.

Addressing the Potential Risks of "Mineral-Free Purified Water"

Long-term consumption of mineral-free purified water can lead to nutrient deficiencies. Studies show that cooking with soft water can cause significant loss of vital minerals, such as up to 60% of calcium and magnesium, with even greater reductions in some trace elements. Moreover, due to soft water lacks minerals, it is more likely to absorb toxins and heavy metals from containers, increasing the risk of health issues.

History of Water Purification Technology

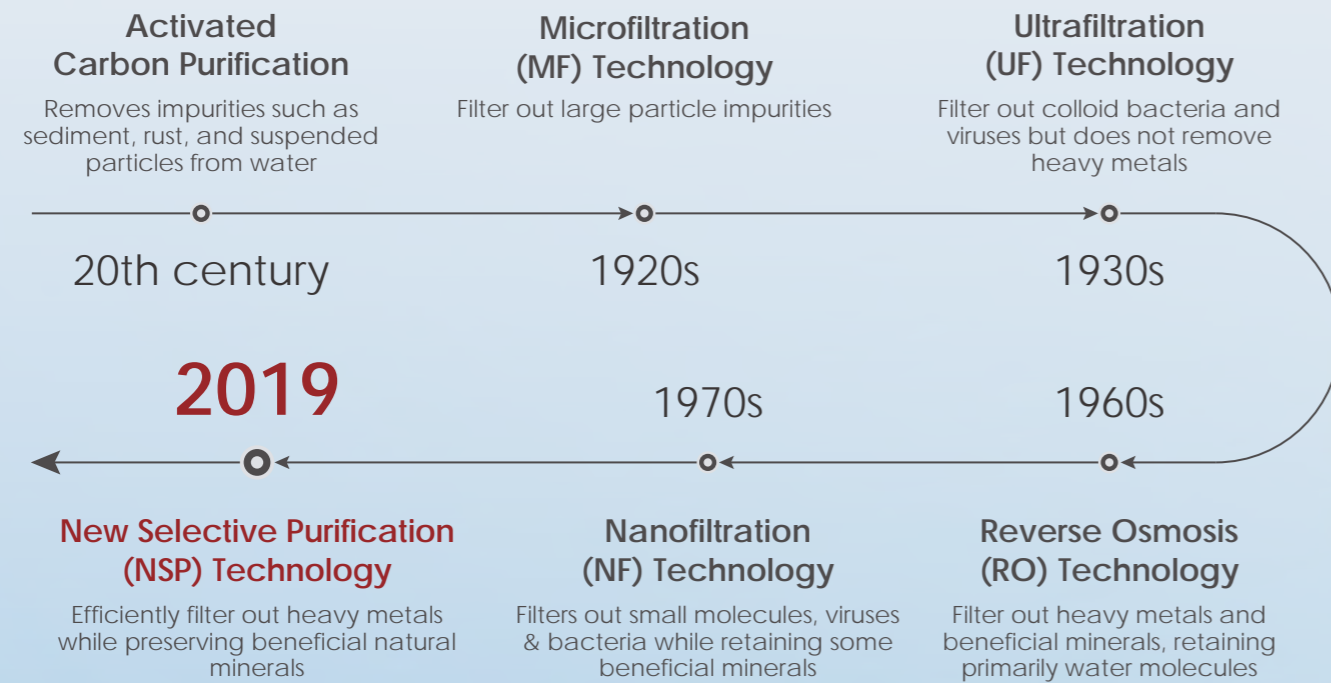

Two Common Types of Water Purification Technologies on The Market: Ultrafiltration and Reverse Osmosis

Ultrafiltration can effectively remove harmful substances like bacteria and viruses, but its larger pore size makes it ineffective against heavy metals. Reverse osmosis uses smaller pore sizes to filter out most heavy metal elements, but it also removes beneficial minerals in the process.

Due to minerals and heavy metals are similar in size, achieving the selective removal of one while retaining the other was a significant challenge until the advent of FOTILE's New Selective Purification (NSP) Technology*.

* Patent Number: ZL201710982839.3.

- | | | |
|---------------------------------------|---------------------------------------|--|
| ✓ Retains Beneficial Natural Minerals | ✓ Retains Beneficial Natural Minerals | ✗ Does Not Retains Beneficial Natural Minerals |
| ✗ Does Not Filters Out Heavy Metals | ✓ Filters Out Heavy Metals | ✓ Filters Out Heavy Metals |



Removing Heavy Metals While Retaining Beneficial Natural Minerals

—With 8 Years of Invention, FOTILE has created the New Selective Purification (NSP) Technology

The secret to optimum water purification lies in unique filter membrane. During the research and development process, FOTILE used tons of membrane materials to successfully create this distinctive selective filter. This membrane can accurately identify heavy metal elements in water and selectively capture them, efficiently adsorbing them onto the membrane while allowing beneficial minerals to pass through.

As a result of this targeted filtration process, the water that flows from FOTILE's NSP water purifier is "pure mineral-rich water," free of most bacteria and harmful heavy metals, while still retaining essential mineral elements for the body.

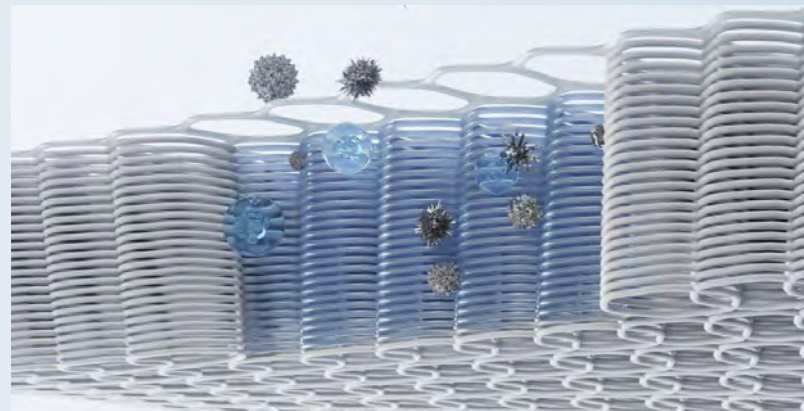

Retaining Beneficial Natural Minerals

New Selective Purification (NSP) Technology effectively retains over 90% of essential minerals, including sodium, calcium, and magnesium, ensuring that most beneficial trace minerals remain in the water.



*Retain Beneficial Natural Minerals: Calcium, Magnesium, Potassium, Strontium, Lithium, Selenium, Bicarbonate, Metasilicic Acid.
Filter Out Heavy Metals: Mercury, Chromium, Lead, Arsenic, Tin.

7-Stage Purification with Comprehensive UV Sterilisation

FOTILE enhances its waterway sterilisation by incorporating instantaneous UV-LED technology throughout the entire water path, from the source to the outlet. This system achieves a sterilisation rate of up to 99.999%, ensuring that the water is fresh and safe to drink for your love ones.

NO.1 Foldable PP

Removes sediment, rust, and suspended solids

NO.2 Activated Carbon (C)

Eliminates large particle impurities, odors, and discoloration

NO.3 Nanofiltration (NF)

Adjusts water hardness and removes organic impurities

NO.4 New Selective Purification (NSP)

Removes up to 99% of heavy metals* while preserving beneficial natural minerals*

NO.5 Activated Carbon

Imported coconut shell activated carbon, making drinking water taste sweeter

NO.6 Ultrafiltration (UF)

Enhances bacterial filtration, improving system effectiveness

NO.7 UV-LED Sterilisation

Achieves a sterilisation rate of up to 99.999%*



Polypropylene-Carbon Ultrafiltration Composite (PCF) Filter

Featuring premium coconut shell activated carbon imported from Japan on both the front and back layers, effectively adsorbing residual chlorine and other organic pollutants. It includes an ultrafiltration membrane and folded PP to **prevent bacterial contamination and filter out sediment and rust**. With a contaminant-absorbing surface area six times greater than traditional PP cotton, it provides a longer lifespan, with **only an annual replacement needed**.

Membrane-Selective Nanofiltration (MNF) Filter

Featuring imported nanofiltration membranes and New Selective Purification (NSP) membranes, which adjust water hardness while **removing bacteria, organic matter, small particles, and heavy metals**, all while retaining essential minerals. It is recommended to replace the **filter every two years**.



Maternal and Infant Grade: The purification efficiency of FOTILE's water purifier, including its ability to remove lead, cadmium, hexavalent chromium, and arsenic, as well as its mineral retention capacity, complies with the requirements outlined in RZB093-2022 (Technical Specification for Specialty Product Certification Technical Requirements for Certification of Maternal and Infant Water Purifiers) and GK49 (Implementation Rules for Certification of Special Products).

High Efficiency in Heavy Metals Removal: According to the Zhejiang Provincial Center for Disease Control report (No. 202302439), the water purifier effectively filters out heavy metals such as lead, cadmium, mercury, chromium (VI), and arsenic.

Retention of Beneficial Natural Minerals: The China Household Electrical Appliances Research Institute report (EWCjs-24-672) confirms that the FOTILE's water purifier retains essential minerals like calcium, lithium, strontium, and metasilicic acid.

Comprehensive Sterilisation: The Zhejiang Micro Testing reports (No. B211209-03 & No. B230627-46) shows that the the FOTILE's water purifier's sterilisation module achieves a 99.999% killing rate of E. coli, while the UV sterilization faucet has a 99.40% elimination rate.

99.999% Bacterial Reduction Rate: FOTILE's water purifier's sterilisation module eliminates 99.999% of E. coli, as per the Zhejiang Micro-test report (No. B211209-03).

Comprehensive Triple UV Sterilisation for Fresh and Pure Water

Triple UV sterilisation*, including a UV-LED at the faucet outlet to ensure your drinking water is safe and clean.

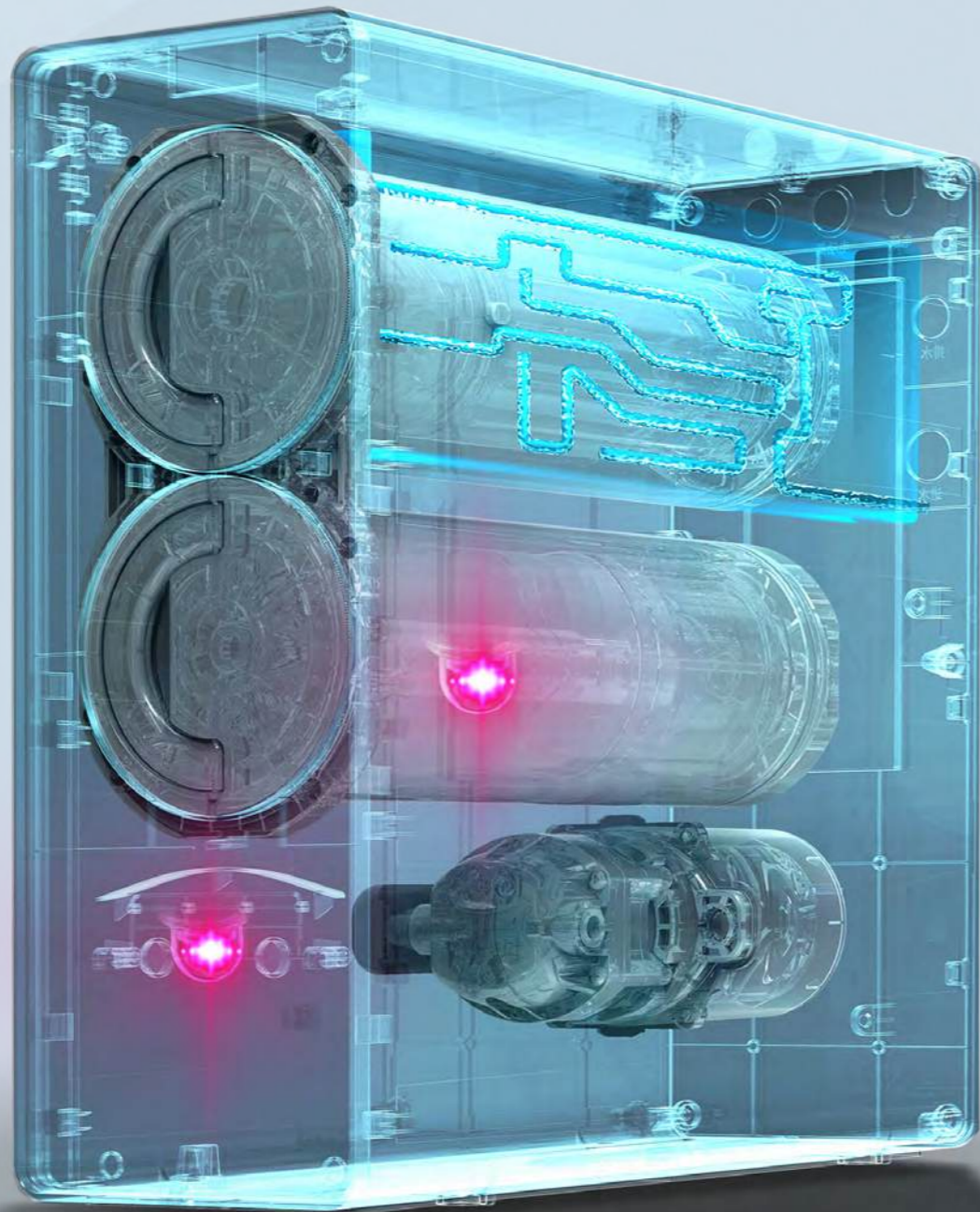

1

UV-LED Sterilisation
[Water Flow System]

Performance Upgraded
In-Line UV, rapid response
with a sterilisation rate up to
99.99%.



2

UV-LED Sterilisation
[Steady-Flow Buffer]

Timed Circulation
Achieves a 99.99% sterilisation
rate.



3

UV-LED Sterilisation
[Faucet Outlet]

Quick activation
High antibacterial
efficiency.

Thick Film Rapid Heating Technology

5-Temperature Settings for Instant Beverages

Our water purifier employs the pioneering thick film rapid heating technology, offering multiple temperature settings and delivering hot water in just three seconds. Enjoy instant access to heated and purified beverages on demand, without any waiting time or the need for storage.



Thick Film Rapid Heating Technology

Skip waiting, say no to overheated water.



Convenient Operation with One Touch

FOTILE's NSP water purifier features an advanced, user-friendly faucet with independent installation and water dispensing. Its intuitive touch interface provides a seamless user experience.



Humanised Design



User-friendly Filter Replacement

No need to move the unit; simply open the cabinet, twist and pull to replace the filter.



Authenticity Verification

Genuine filters are protected against counterfeits for peace of mind.



Filter Lifespan Monitoring

The screen displays when the filter is due for replacement, eliminating the need to bend down, and automatically resets after changing the filter.



Anti-Scald Design

Multilayered thermal insulation design, ensuring effective protection against scalding.



Smart Voice Assistance

Voice prompts are integrated to provide helpful reminders to users.

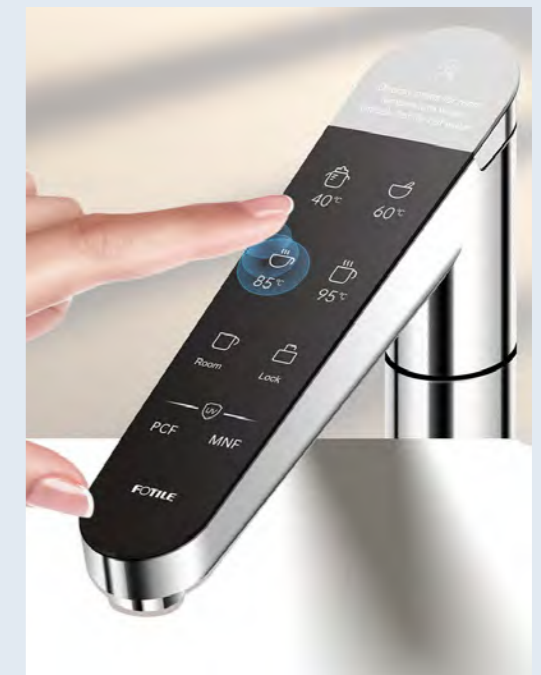



Our Outstanding Honors



Standard and Industrial
Research Institute of Malaysia



International Electrotechnical
Commission



IFANCE HALAL PRODUCT CERTIFICATE شهادة حلال



Certification Center of Light
Industry Council co., LTD
(Maternal and Infant Grade)



Standard & Quality
of Light Industry
(Maternal and Infant Grade)



China National Intellectual
Property Administration
Patent No. ZL 2017 1 0982839. 3
ZL 2021 1 1126661. 5

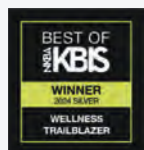

Best of KBIS
Wellness Trailblazer
(US)



International Society of Scientific
Communication for Nobel Prize Laureate



China Household
Electrical Appliances Association

Design:



iF Product
Design Award



Reddot
Design Award



China Household
Electric Appliance Research Institute
(Design)



HJT1800-HR7

Certification	CB, SIRIM, Halal
Water Purifier Type	Tankless
Heating Material	444 Stainless Steel
Filter Type	PCF, MNF
Power Consumption, Voltage, Frequency	2200W, 240V, 50Hz
Inlet Water Temperature	5°C - 38°C
Temperature Control	Room, 40°C, 60°C, 85°C, 95°C
Flow Rate (L/min)	1.8
Automatic Filter Replacement Indicator	Body + faucet screen display + smart voice assistance
Filter Lifespan	PCF: 12 Months MNF: 24 Months
Household Water Pressure	0.1MPa-0.4MPa
Product Dimensions (W x D x H) (mm)	435.6 x 160.6 x 434.6

Seamless Design, Space-Saving, Easy Installation

Recommended Location for Installation ①

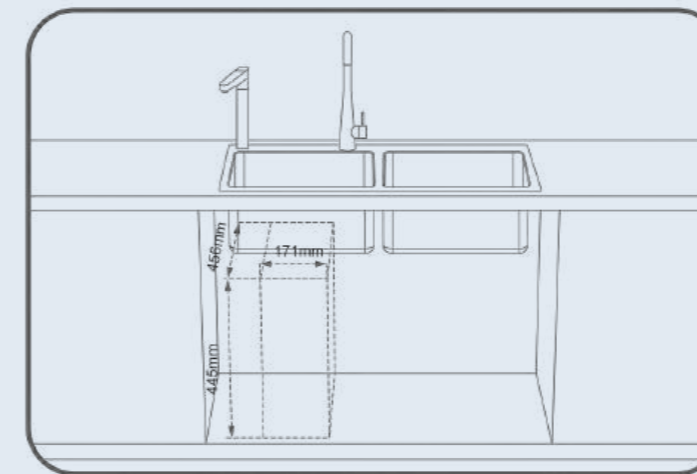

Recommended Location for Installation ②

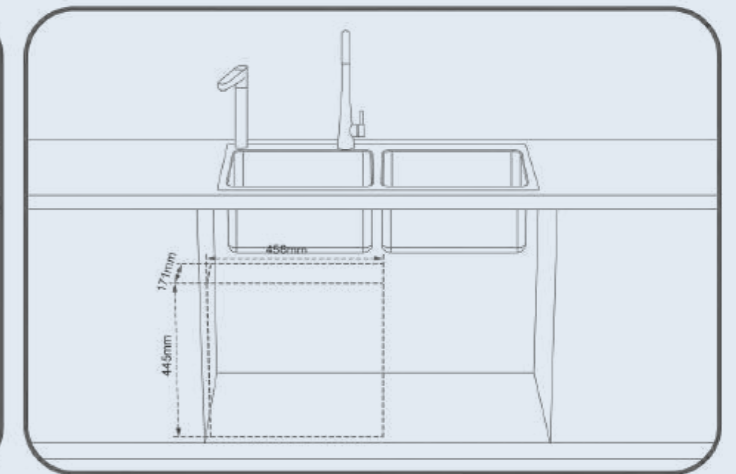

Wiring Diagram

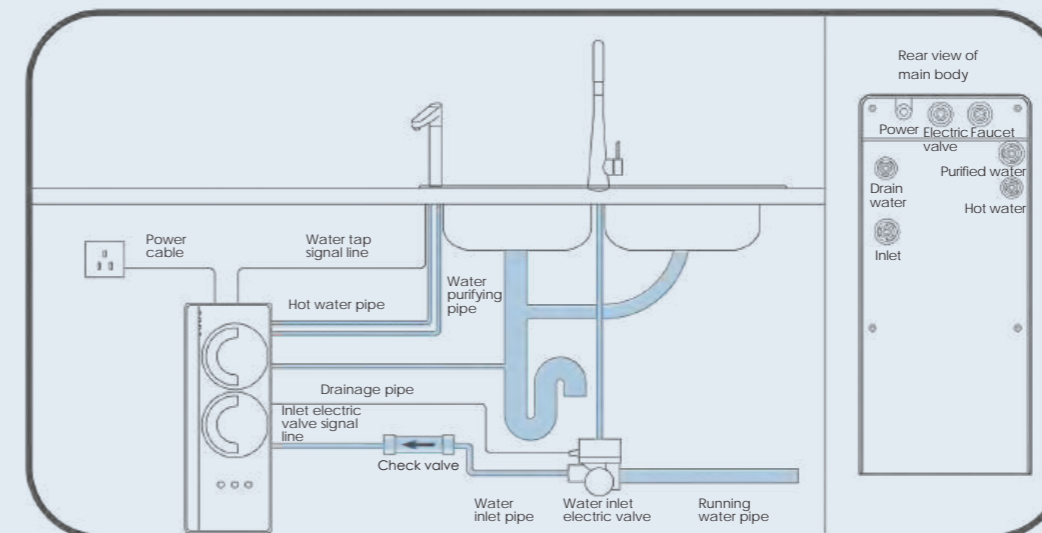

Faucet Installation Hole

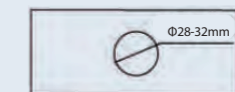

Water Purifier Installation Guide

Before Installation Requirement:

1. The water outlet & water inlet must be near to water purifier.
2. Drill holes with the diameter of 28mm~32mm on the countertop for water purifier's faucet installation hole.
3. Prepare a 13A power point inside the cabinet.
4. Thickness of the countertop must be < 25mm.